

# FIRST & CALVARY PRESBYTERIAN CHURCH BUILDING MAP—FIRST FLOOR

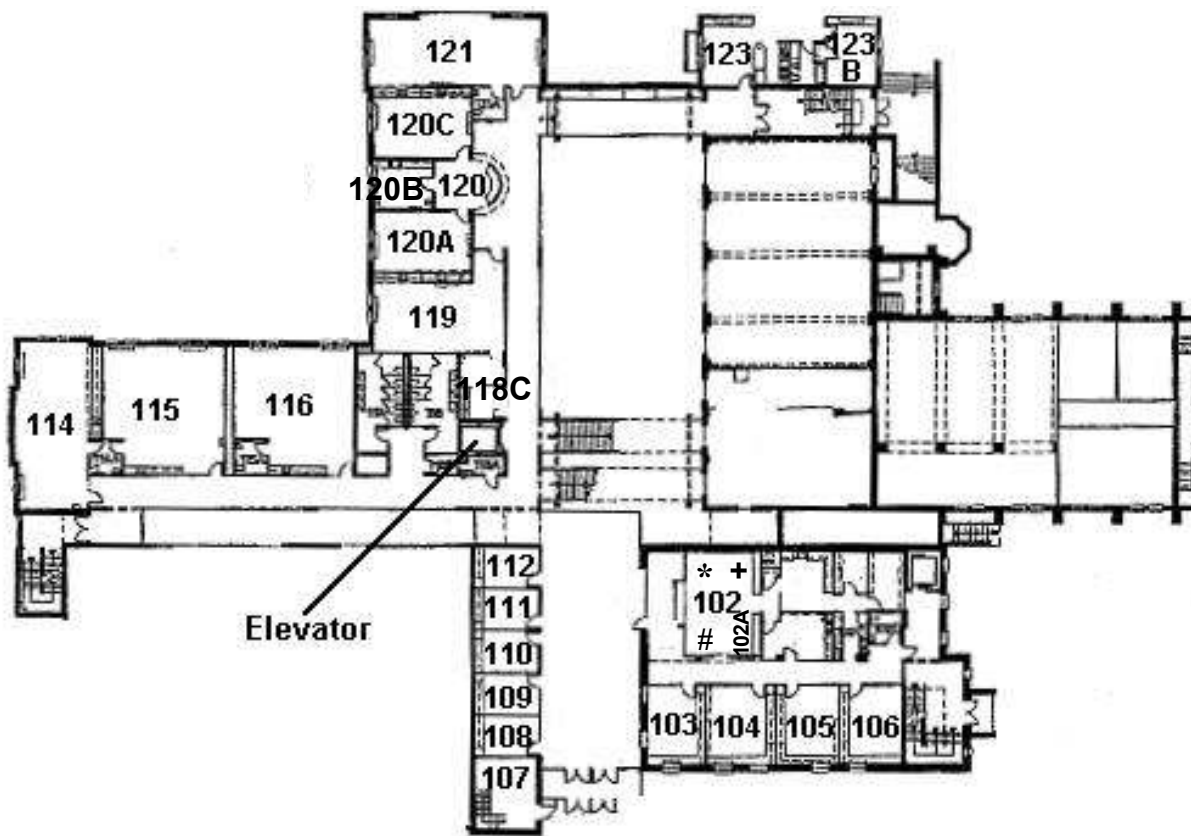

102	Administrative Office * Debbie Rollinson-Membership Care Secretary +Claire Gidman-Christian Education Secretary # Nancy Myers-Receptionist	114	Encounter Classroom
102A	Sandy Durham-Office Manager	115	Forty-Niners Classroom
103	Sharon Burden-Church Administrator	116	Hardin Classroom
104	Greg Seckman-Senior Pastor	118C	Cry Room
105	Ministry Coordinator-Greg Ellis	119	Childcare Room
106	Associate Pastor	120	Nursery Check-In
107	Nola Harter-Financial Secretary	120A	Nursery (Under 1 Year)
108	Sheila Grisham Pippin-Director of Music Ministry	120B	Early Childhood Ministries Storage
109	Sharon Reed-Director of Contemporary Worship	120C	Nursery (Newborns, crawlers, walkers)
110	Terri Blackmon-Christian Education Director	121	Toddlers (2 Year Olds)
111	Carmen Stokes-Children's Ministries Director	123	Apartment
112	Mike Thurman-Buildings & Grounds	123B	